

Transferring the Design with a Hot Iron

Getting Ready...

Cut out the design and leave a 5 mm (0.2 in.) border all around the design in order to achieve a clean transfer. Do not cut into the design. If the design is cut, ink may run out from under the transfer sheet when the iron is applied and smear the cloth.

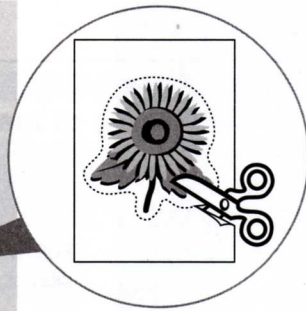

1 Clear an area on a hard surface like a heavy table, desk, or workbench.

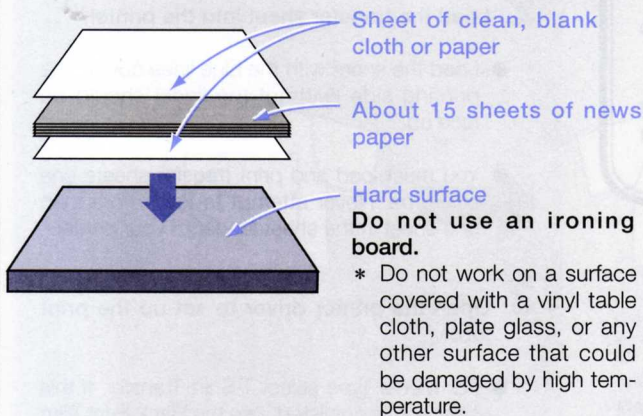

2 Position the transfer sheet and the T-shirt.

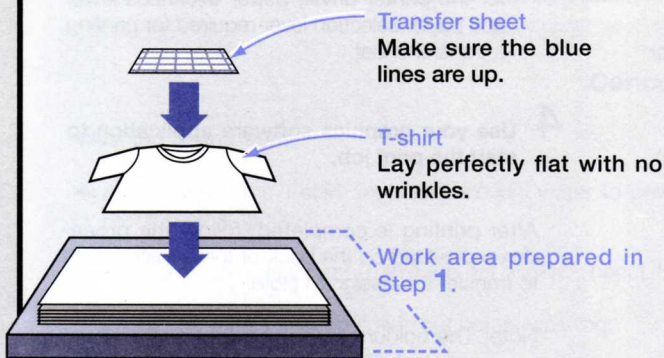

3 Switch on the iron and adjust for the highest setting.

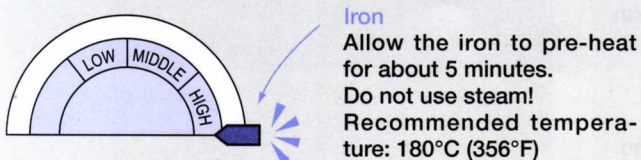

4 Temporary pressing

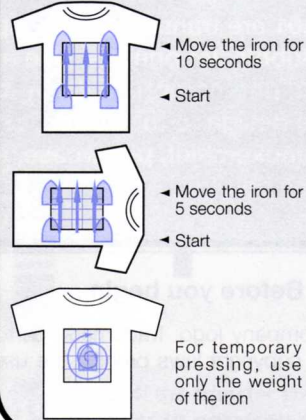

Place the transfer sheet on a clean, unwrinkled T-shirt where the transfer is to be made with the blue lines facing up.

In order to set the transfer sheet in place, iron the sheet working from the center to the outside.

For temporary pressing, use only the weight of the iron

Hints for a successful transfer!

- ⚡ **Cautions concerning iron temperature**
Depending on the iron you are using, the temperature may be above or below the recommended temperature.
 1. Lower than recommended temperature: the transfer sheet does not stick to the T-shirt even when moving the iron once or twice using its own weight during temporary pressing. In this case, apply pressure so that sufficient heat is transferred when ironing. If the temperature of the iron is too low, the transferred image will peel off when washing.
 2. Higher than recommended temperature: the transfer sheet completely sticks to the T-shirt when moving the iron once or twice using its own weight during temporary pressing. In this case, take caution as to not burn the T-shirt when ironing.

- ⚡ **Stand over the iron and use both hands to apply about 20 kg (44 lb.) of pressure.**

- ⚡ **Press straight down; do not slide the iron across the transfer sheet.**

- ⚡ **Without twisting the iron, apply it from edge to edge over the entire transfer sheet.**

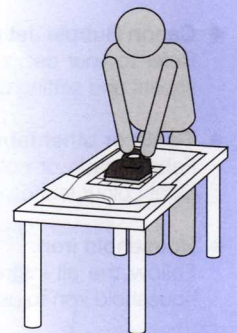

- ◆ The amount of time required to transfer the design from the transfer sheet may be determined by what type of iron you are using. Keep the iron pressed down on the transfer sheet until you see the transfer sheet change into light brown.

- ◆ Make sure the transfer sheet and fabric are perfectly smooth before you apply pressure with the iron. Never apply pressure with the iron when the transfer sheet is on a wrinkle, kink, or uneven surface.

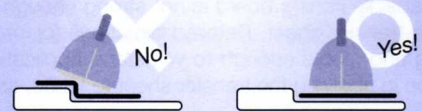

- ◆ If you intend to transfer a design to a jersey patch for a sports event, transfer the design to the patch before you attach the patch to a jersey or T-shirt.

Applying Heat and Pressure with the Iron

With the iron horizontal to your body, press down evenly.

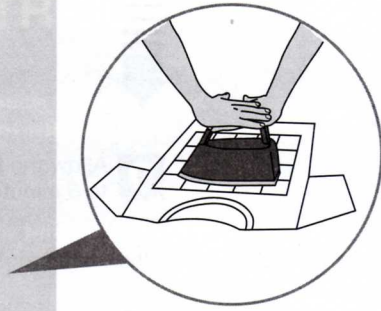

- Take caution as the T-shirt may burn when pressing down on the iron in one location for more than 5 seconds.
- Work carefully to avoid minor burns! The transfer sheet is extremely hot during and immediately after ironing.
- To minimise the unpleasant odour of the heated transfer sheet, work in a well ventilated area.

First Pressing of Entire Transfer Sheet

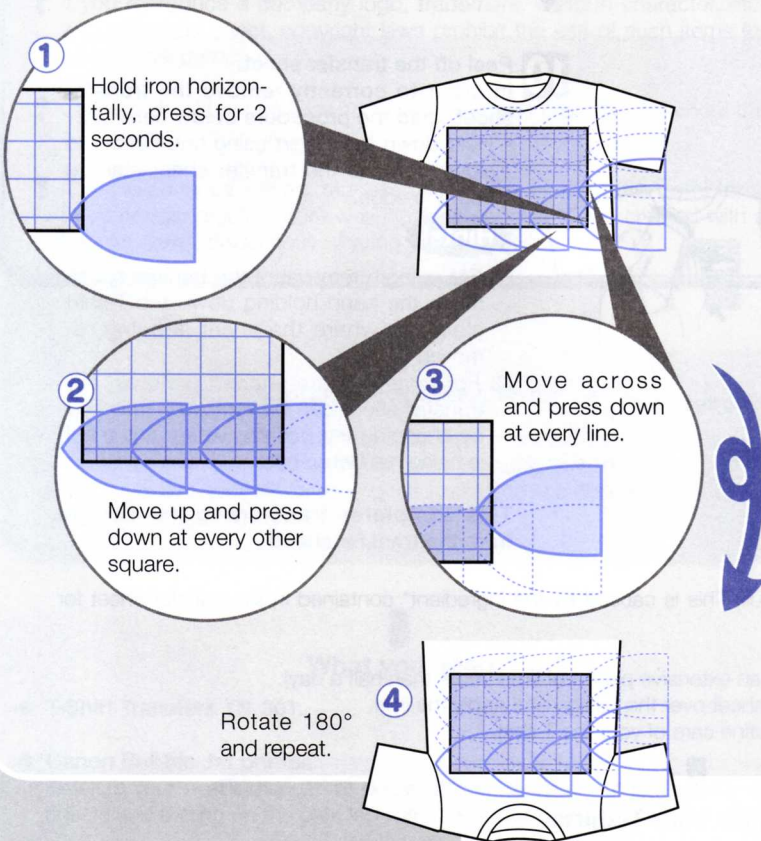

1 Position the iron on the first intersection of the blue lines on the transfer sheet (1) and press down on the iron for 2 seconds with about 20 kg (44 lb.) of pressure.

2 Move the iron up the grid in a straight line stopping at every other square, holding the iron down for 2 seconds (2). Repeat this step 4 times.

3 As soon as you finish one straight line, start the next line repeating (1, 2) until you have repeated the procedure for all the lines (3).



If you are using a cordless iron, allow the iron to recharge for every straight line of ironing.

4 Rotate the T-shirt 180° and repeat Steps 1, 2, and 3 (4).



If you are using a cordless iron, allow the iron to recharge for every straight line of ironing.

Second Pressing of Outer Edges

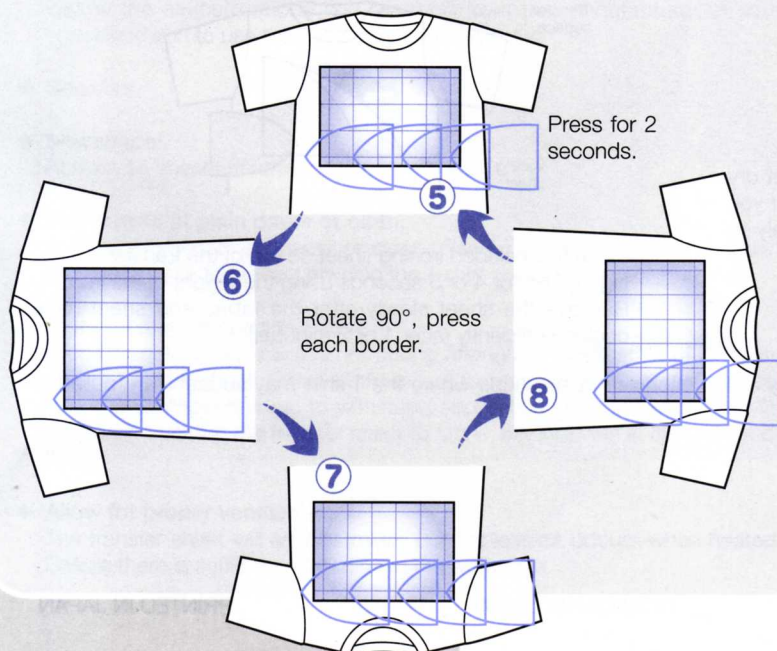

5 Repeat Steps 1 and 2, and press the outline of the transfer sheet (5).

6 Rotate the T-shirt 90° and repeat Step 5 for each edge of the transfer sheet (6~8).



If you are using a cordless iron, allow the iron to recharge for every straight line of ironing.

7 Repeat the pressing of the left, top, right, and bottom edge of the transfer sheet (5~8).

8 Iron the transfer sheet working from the center to the outside applying all your weight so that the surface of the entire transfer sheet is smoothed out.



Transferring the Design with a Hot Iron

Applying Heat and Pressure with the Iron

Allowing the Transfer Sheet to Cool

9 Allow the transfer sheet to cool for about 3 to 5 minutes.

- ◆ If you intend to transfer a design to the opposite side of the T-shirt, repeat the entire procedure to transfer the other design before you peel off the transfer sheet you have just applied.

Peeling off the Transfer Sheet

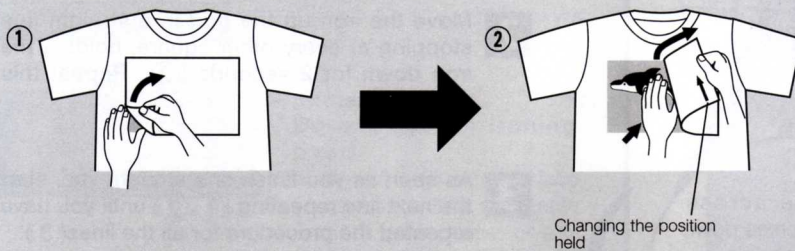

10 Peel off the transfer sheet. In order to correctly remove the transfer sheet, read the procedure below carefully.

- Hold down the T-shirt using one hand and slowly remove the transfer sheet starting from the edge.

Hints!

- ① For smooth removal of the transfer sheet, move the hand holding down the T-shirt closer to where the sheet is being removed.
- ② For large, square-shaped pictures, the transfer sheet can be removed smoothly by changing the position where the sheet is being held while peeling.

This completes transferring the design from the transfer sheet!

- ◆ The surface of the image may occasionally appear dull. This is caused by the ingredient* contained in the transfer sheet for smooth removal and will disappear after washing.
- *This ingredient is harmless to the human body.
- ◆ Do not leave the transfer sheet stuck to the T-shirt for an extensive period of time (more than half a day).
- ◆ If the image shows signs of peeling, place the ironing sheet over the design and apply the iron.
- ◆ Refer to the instructions below for directions about routine care of your the T-shirt.

Caring for Your T-shirts

Washing Instructions

- ◆ Always wash the T-shirt separately in cool water to prevent staining other fabric.
- ◆ Always machine wash the T-shirt (do not wash by hand).
- ◆ Always turn the T-shirt right side out before washing.
- ◆ Never use bleach.
- ◆ After washing the T-shirt, dry it immediately. If you do not dry the T-shirt immediately, dye from the transfer may run. If you use an electric tumble dryer, dry each T-shirt separately to prevent staining other fabric.
- ◆ Never use water-proofing spray on the transfer.

* T-shirts with transfers are not intended for use in heavily active sports or in situations where the T-shirt may suddenly be pulled or stretched.

Ironing Instructions

- ◆ If the transfer starts to show signs of wrinkling after washing, iron the transfer again using the following procedure:

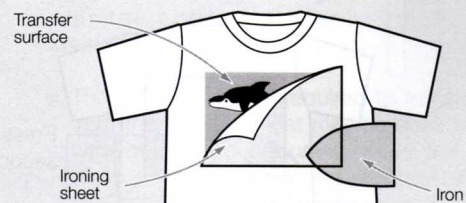

- Place the included ironing sheet on top of the transfer.
- Lightly iron for 4 or 5 seconds using the weight of the iron.
- Remove the sheet slowly after the fabric and sheet have cooled sufficiently (after 1 or 2 minutes).